

T8_{LTE}

IoT tracking device

T8LTE is a small IoT tracking device uniquely designed for safe flight operations and long-term tracking of all assets and equipment.

It is built on advanced sensor technology, and it features the low power network technology LTE Cat-M1, long battery life, easy installation and a robust casing.

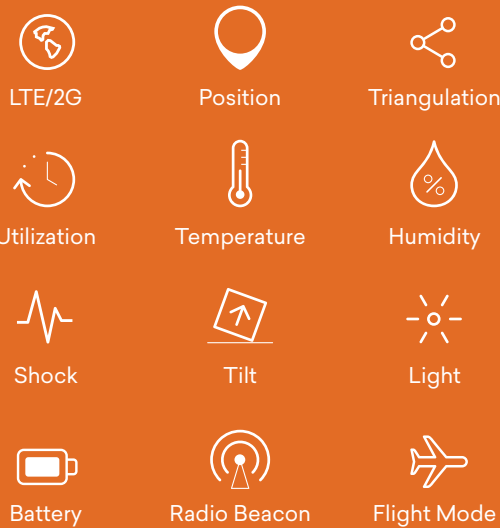

T8LTE is a unique IoT product featuring the low power communication technology LTE Cat-M1. It typically offers 5 years battery lifetime based on 1 position/day.

The robust casing is suited for all industrial environments and all-weather conditions with an operating temperature range from -30°C to +85°C.

T8LTE provides global connectivity of any asset; both powered and non-powered equipment and entire fleets. It is primarily designed for flight operations and industries like transport and logistics, construction, wind power, rental, and theft protection and recovery.

T8LTE uses high-quality batteries designed for safe flight operations that comply with flight safety regulations. A flight mode feature suppresses radio transmissions to ensure safe conditions during flight.

T8LTE transmits data to a cloud-based management software that provides complete visibility and predictive analytics on location, performance, and status of assets and equipment.

Transmissions can be set at fixed intervals and if specified events occur. Devices out of data coverage will log sensor input until coverage is available again.

The built-in 3-axis accelerometer will trigger accurate data on motion, shock, tilt and utilization, while other sensors track temperature and light.

Positions are acquired by GPS and via mobile network triangulation if GPS is not possible. A built-in radio beacon can be activated for close-range location.

Specifications

Battery lifetime	Typical 2900 transmissions based on 1 transmission/day *
Sensors	Position, Motion, Tilt, Temperature, Light, Utilization, 3-axis Shock (up to 8 g)
Log	Store-and-forward log, up to 200 entries of all data incl. position and sensor data
Network technology	LTE Cat-M1, GSM
Antenna, GPS	Internal
Antenna, LTE/2G	Internal
Antenna, radio	Internal
Radio beacon	UHF
SIM	Embedded, subscription required
Server communication	LTE/2G with SMS backup
Server protocols	API available upon request
Configuration	Via server
Temperature, operating	-30°C to +85°C
Temperature, storage	-40°C to +85°C
Housing	PA6 (nylon) potted with epoxy
IP rating	IP69k
Maximum allowed continuous acceleration	8 g
Dimensions	68 x 68 x 28 mm
Weight	190 g
Battery package	26 Wh (2 x primary lithium, encapsulated)
Lithium content	< 2 gram
ADR / IATA	UN3091, PI970 Section II
US content	0%
ECCN	EAR99
HS (TARIC export) code	8526912020

Typical number of transmissions

Network	LTE	LTE/2G **	2G
1 transmission/day	2900	2600	2300
4 transmissions/day	5000	4000	3200
24 transmissions/day	6000	4800	3700

Without GPS, add 10% to above.

*) Depending on signal and temperature conditions

**) 50% LTE and 50% 2G

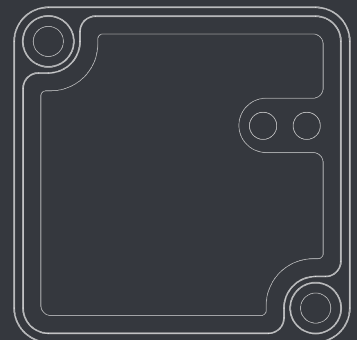
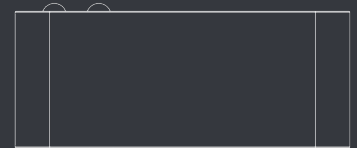
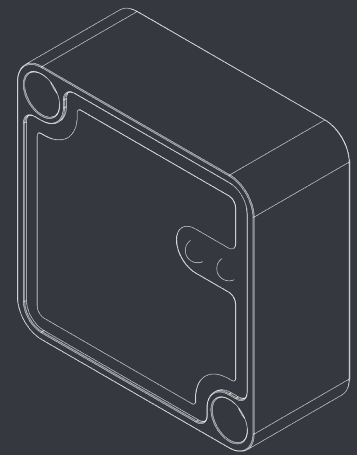

Version 5.0 - Subject to change without notice.
This data sheet references to firmware 3.05 or newer.