

# T7 LTE

## IoT tracking device

T7LTE is a small IoT tracking device for long-term tracking and monitoring of assets and equipment globally.

It is built on advanced sensor technology, and it features the low power network technology LTE Cat-M1, long battery life, easy installation and a robust casing.

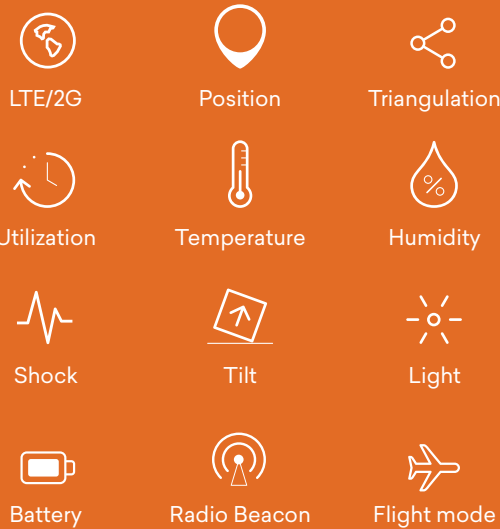

T7LTE is a unique IoT product featuring the low power communication technology LTE Cat-M1. It typically offers 5 years battery lifetime based on 1 position/day.

The robust casing is suited for all industrial environments and all-weather conditions with an operating temperature range from -30°C to +85°C.

T7LTE provides global connectivity of any asset, both powered and non-powered equipment and entire fleets. It is primarily designed for heavy industries like transport and logistics, rail, construction, wind power, rental, and theft protection and recovery.

T7LTE transmits data to a cloud-based management software that provides complete visibility and predictive analytics on location, performance, and status of assets and equipment.

Transmissions can be set at fixed intervals and if specified events occur. Devices out of data coverage will log sensor input until coverage is available again.

The built-in 3-axis accelerometer will trigger accurate data on motion, shock, tilt and utilization, while other sensors track temperature and light.

Available external wireless RHT and RFID-tags offer humidity sensor and additional temperature data.

A flight mode feature suppresses radio transmissions to ensure safe conditions during flight.

Positions are acquired by GPS and via mobile network triangulation if GPS is not possible. A built-in radio beacon can be activated for close-range location.

## Specifications

Battery lifetime	Typically 4000 transmissions based on 1 transmission/day *
Sensors	Position, Motion, Tilt, Temperature, Light, Utilization, 3-axis Shock (up to 8 g)
Log	Store-and-forward log, up to 200 entries of all data incl. position and sensor data
Network technology	LTE Cat-M1, GSM
Antenna, GPS	Internal
Antenna, LTE/2G	Internal
Antenna, radio	Internal
Radio beacon	UHF
SIM	Embedded, subscription required
Server communication	LTE/2G with SMS backup
Server protocols	API available upon request
Configuration	Via server
Temperature, operating	-30°C to +85°C
Temperature, storage	-40°C to +85°C
Housing	PA6 (nylon) potted with epoxy
IP rating	IP69k
Dimensions	68 x 68 x 25 mm
Weight	170 g
Battery package	29 Wh (3 x primary lithium, encapsulated)
Lithium content	2,07 gram
ADR	UN3091
US content	0%
ECCN	EAR99
HS (TARIC export) code	8526912020

## Typical number of transmissions

Network	LTE	LTE/2G **	2G
1 transmission/day	4000	3000	2500
4 transmissions/day	6000	4500	3500
24 transmissions/day	7000	5500	4000

Without GPS add 10% to above.

\*) Depending on signal and temperature conditions

\*\*) 50% LTE and 50% 2G

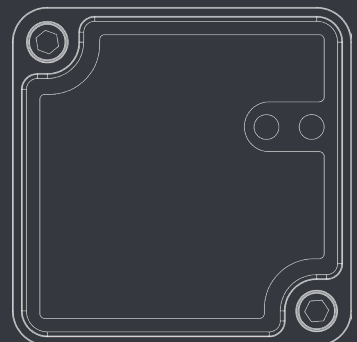
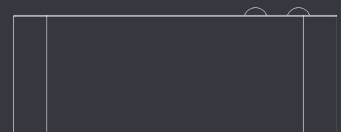
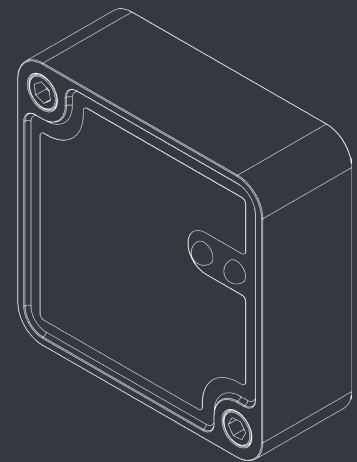

Version 5.1 - Subject to change without notice.